

Quick Frame

for Portable Cabins & Containers



EN: ASSEMBLY INSTRUCTIONS FOR PREFABRICATED MODULES



www.edilmetas.it/en



info@edilmetas.it
www.edilmetas.it



Ph. +39 0835 30 28 04
F. +39 0835 30 79 42



Via G.B. Pirelli- Z.I. La Martella
75100 - Matera - Italy

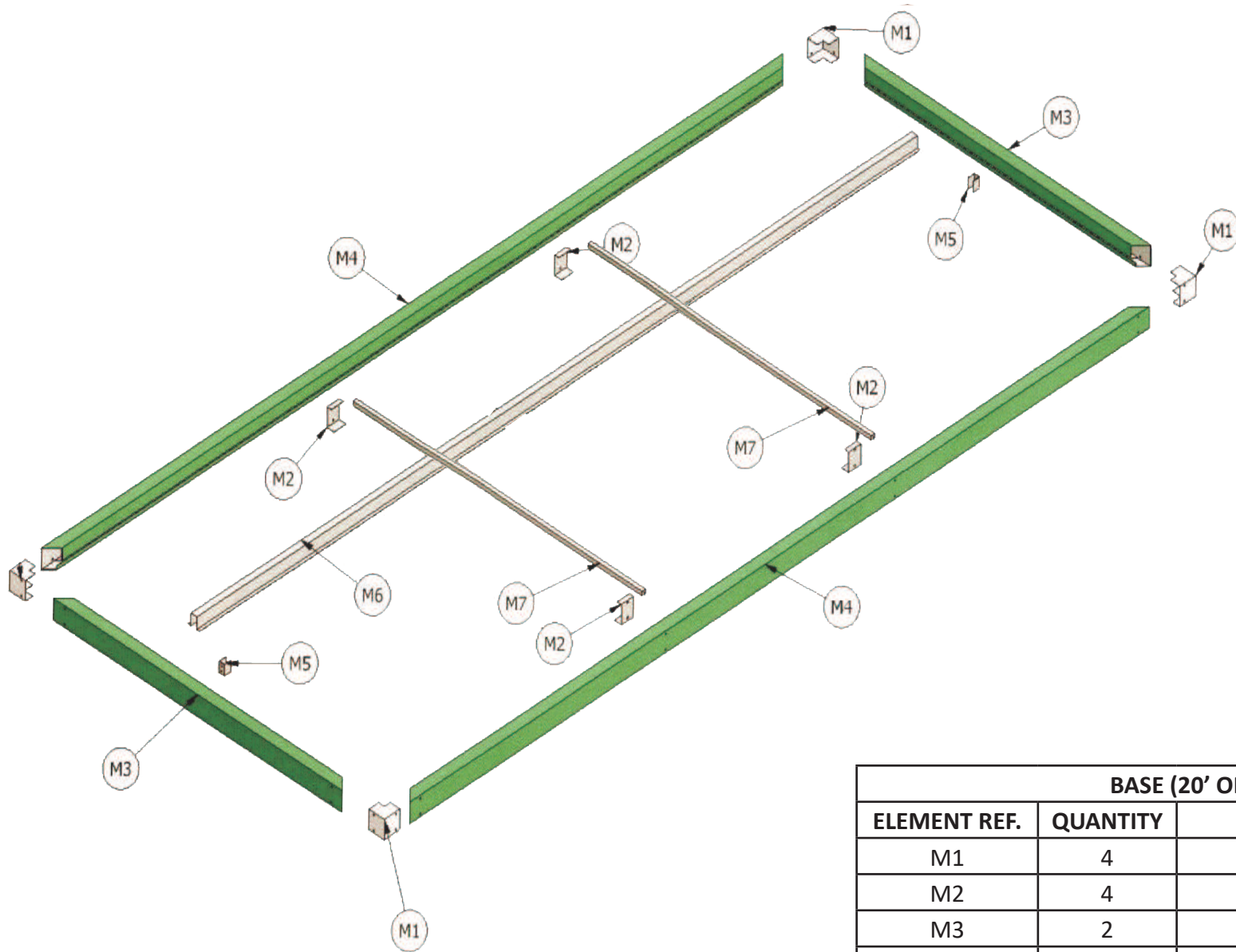

1. Place the FRAMES (M4, M3) on a base, put CORNER JOINTS (M4) inside FRAMES (M3,M4) and secure these with rivets.

2. Use rivets to secure omega support (M5) in the middle of frames (M3). Then, place OMEGA CORE STRUCTURE (M6).

3. Use bolts to secure CENTRAL SUPPORTS (M2) to FRAMES (M4) where the holes are placed. Then, place SPACER-SUPPORT in between these.

| BASE (20' OR LONGER) | | |
|----------------------|----------|-----------------------|
| ELEMENT REF. | QUANTITY | DESCRIPTION |
| M1 | 4 | CORNER JOINT |
| M2 | 4 | CENTRAL SUPPORT |
| M3 | 2 | BASE SHORT SIDE FRAME |
| M4 | 2 | BASE LONG SIDE FRAME |
| M5 | 2 | OMEGA SUPPORT |
| M6 | 1 | OMEGA CORE STRUCTURE |
| M7 | 2 | SPACER-SUPPORT |

4. slot in the GALVANISED SLAB SHEETS (M10) in the FRAMES.

5. Secure with screws the GALVANISED SLAB SHEETS (M10) to FRAMES.

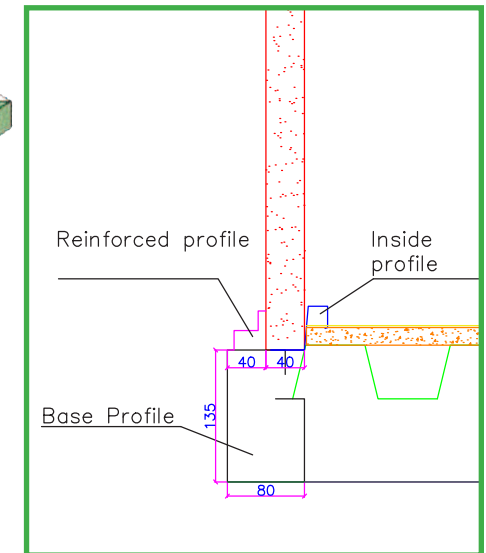
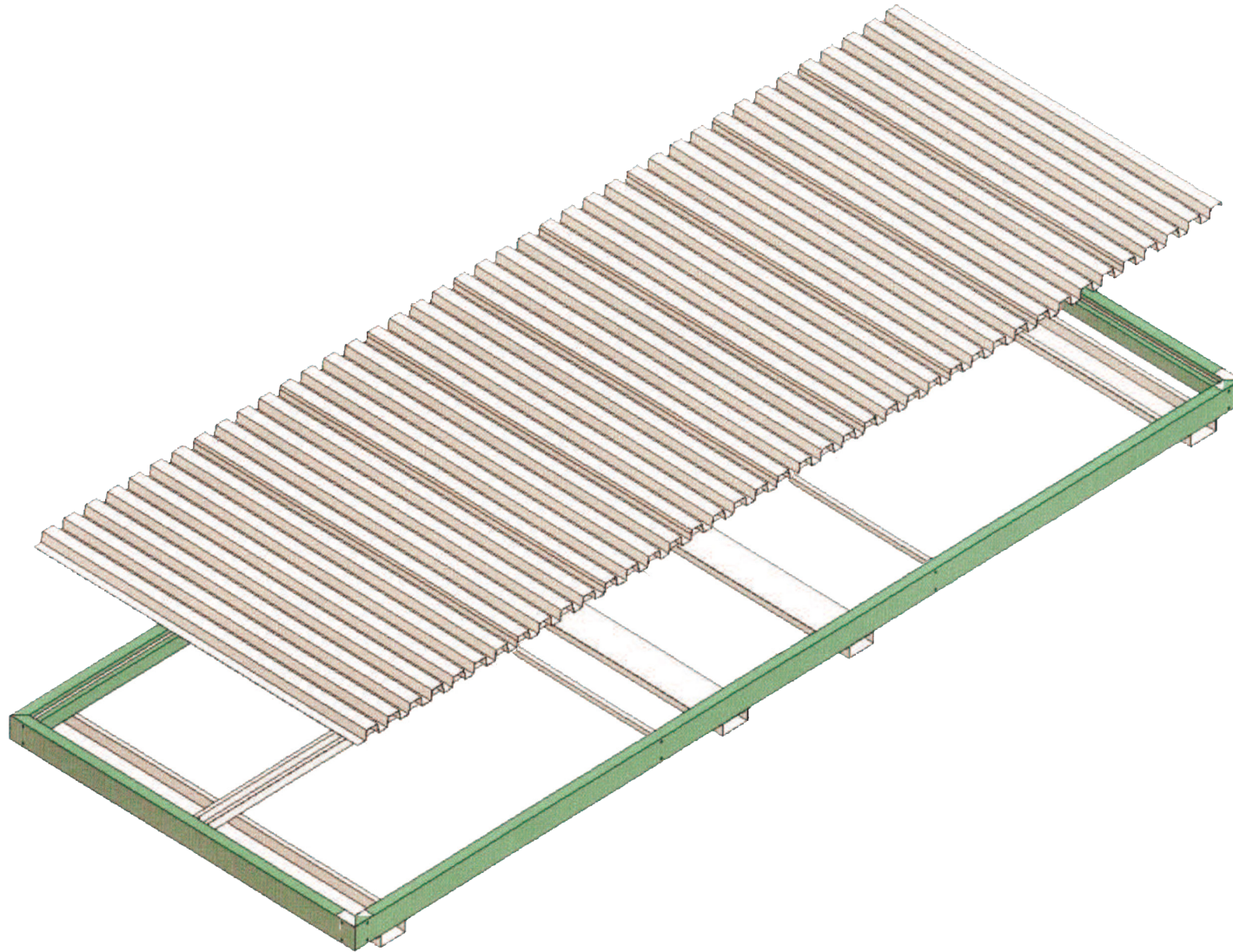

| BASE (20' OR LONGER) | | |
|----------------------|----------|----------------------------|
| ELEMENT REF. | QUANTITY | DESCRIPTION |
| M10 | - | GALVANIZED SLAB SHEET |
| MFORK | - | FORKLIFT POCKET (OPTIONAL) |

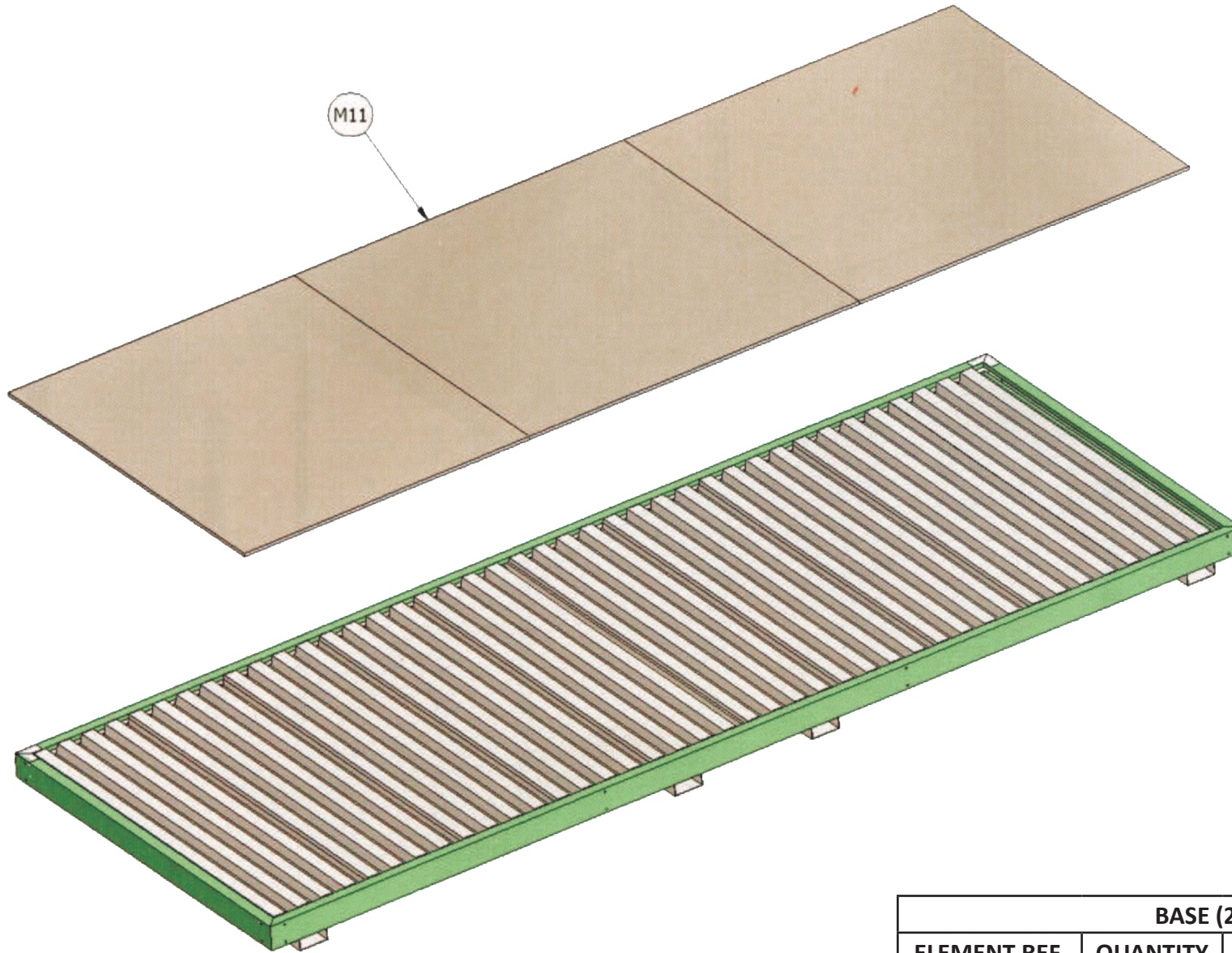

6. Place the WOOD PANELS (M11) over the GALVANISED SLAB SHEET. Fix WOOD PANELS with screws over the GALVANISED SLAB SHEET.

6b. Lay out PVC Vinyl Flooring (OPTIONAL)

7. Fix INSIDE PROFILES PANELS HOLDER (M12)

| BASE (20' OR LONGER) | | |
|----------------------|----------|--------------------------------|
| ELEMENT REF. | QUANTITY | DESCRIPTION |
| M10 | - | GALVANISED SLAB SHEET |
| M11 | - | WOOD PANELS |
| M12 | - | INSIDE PROFILE (PANELS HOLDER) |

8. Fix COLUMNS (M25) using bolts

9. Lift ROOF (preassembled using following instructions)

Secure PILLARS (M26) and COLUMNS (M25) to ROOF.

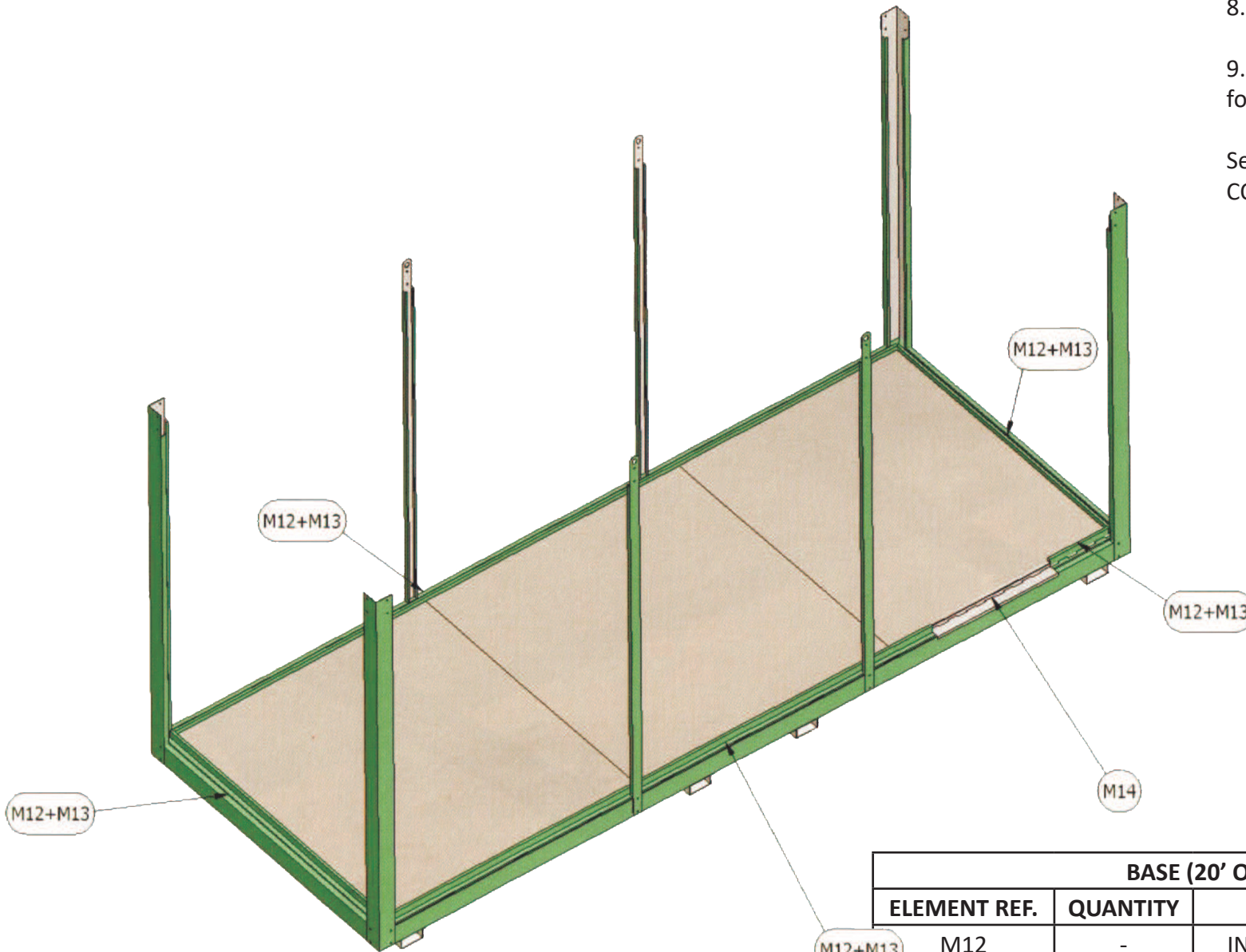

| BASE (20' OR LONGER) | | | |
|----------------------|----------|---------------------------------|--|
| ELEMENT REF. | QUANTITY | DESCRIPTION | |
| M12 | - | INSIDE FINISHING PANELS HOLDER | |
| M13 | - | OUTSIDE FINISHING PANELS HOLDER | |
| MSOG | 1 | GALVANISED DOOR STEP | |
| M25 | 4 | COLUMN | |
| M26 | 4 | PILLARS | |

10. Place the FRAMES (M4, M3) on a base, put CORNER JOINTS (M15) inside FRAMES (M17,M18) and secure these with rivets.

11. Use bolts to secure CENTRAL SUPPORT (M16).

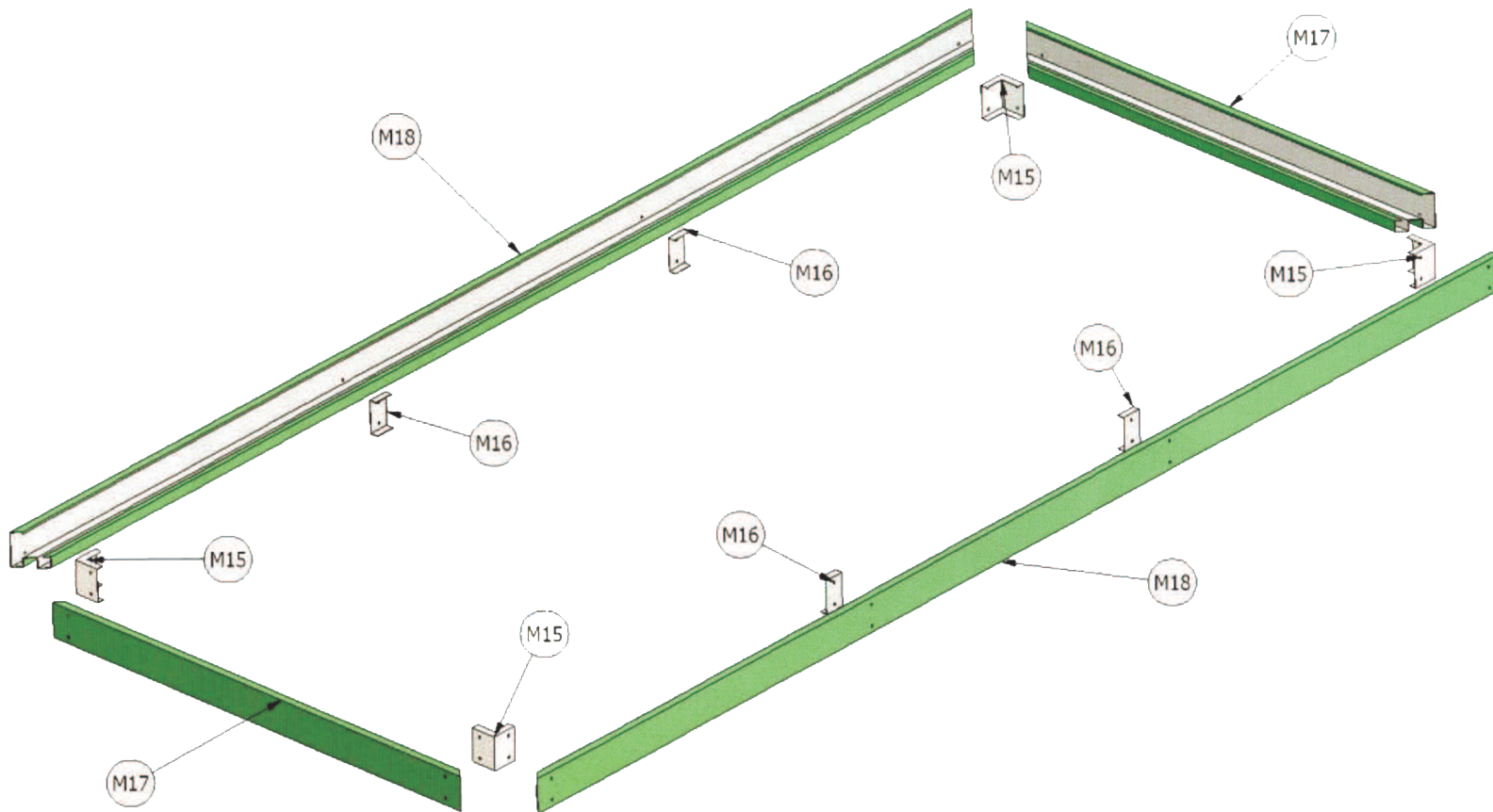

| ROOF (20' OR LONGER) | | |
|----------------------|----------|-----------------------|
| ELEMENT REF. | QUANTITY | DESCRIPTION |
| M15 | 4 | CORNER JOINT |
| M16 | 4 | CENTRAL SUPPORT |
| M17 | 2 | ROOF SHORT SIDE FRAME |
| M18 | 2 | ROOF LONG SIDE FRAME |

12. Use self-drilling screws to fix the panel on the FRAME (M17).

13. Use self-drilling screws to fix sandwich panels on the connection.

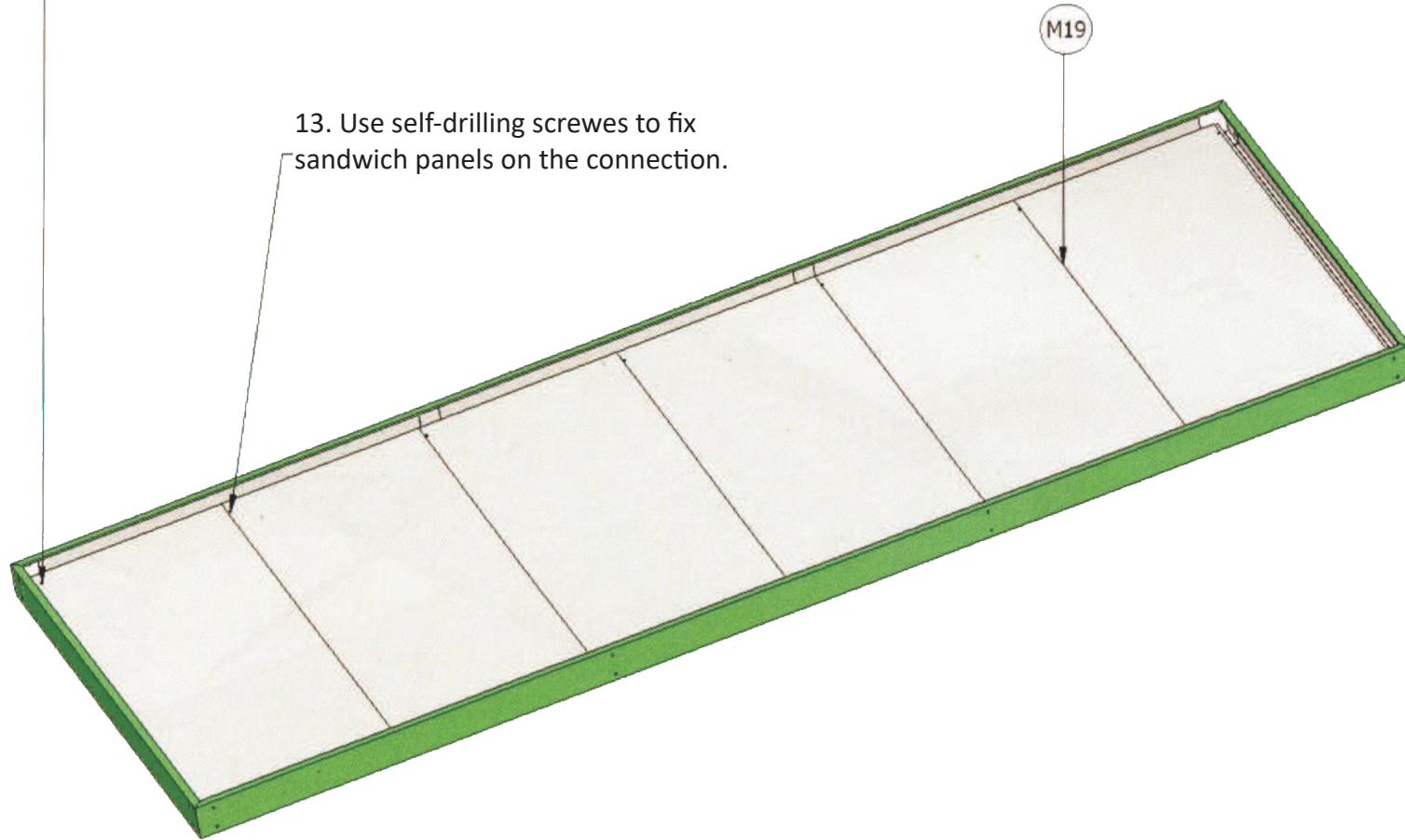

| ROOF (20' OR LONGER) | | |
|----------------------|----------|-----------------|
| ELEMENT REF. | QUANTITY | DESCRIPTION |
| M19 | - | SANDWICH PANELS |

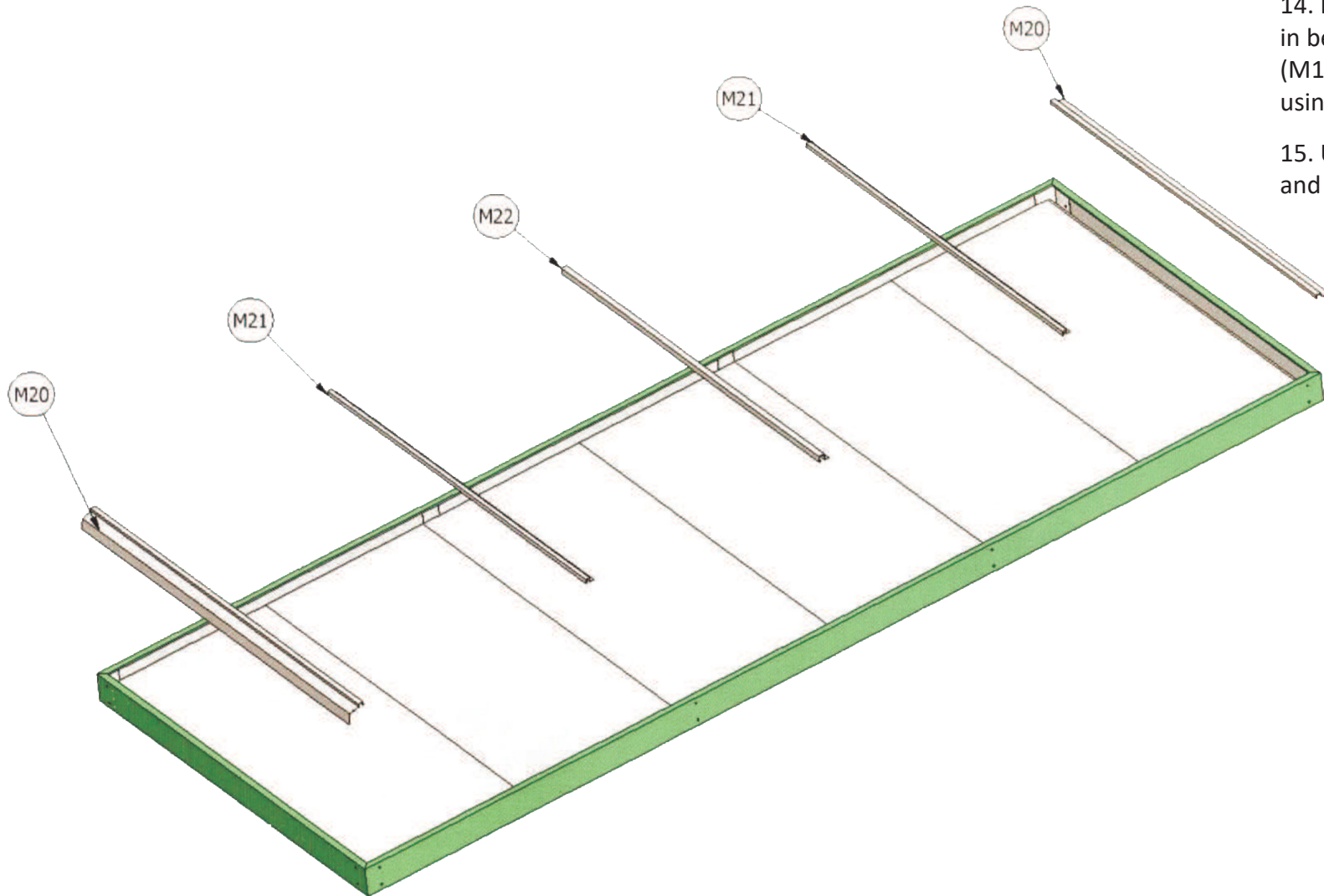

14. Place TUBULAR 30x30x1.5 (M21) in between CENTRAL SUPPORTS (M16). Then, fix these on the panels using two self-drilling screws.

15. Use self-drilling screws to fix M20 and M22 on the panels.

| ROOF (20' OR LONGER) | | |
|----------------------|----------|--------------------------|
| ELEMENT REF. | QUANTITY | DESCRIPTION |
| M20 | 2 | DRIPSTONE |
| M21 | 2 | SLOPE: TUBULAR 30X30X1.5 |
| M22 | 1 | SLOPE: TUBULAR 40X30X1.5 |

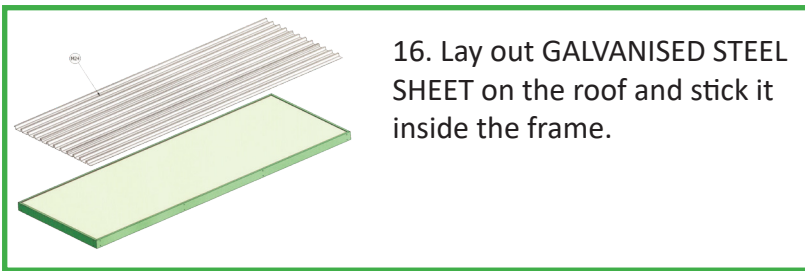

16. Lay out GALVANISED STEEL SHEET on the roof and stick it inside the frame.

16b. FIXING ELEMENTS:
self-drilling screws on the central tubular 40x30x1.2 (M22)

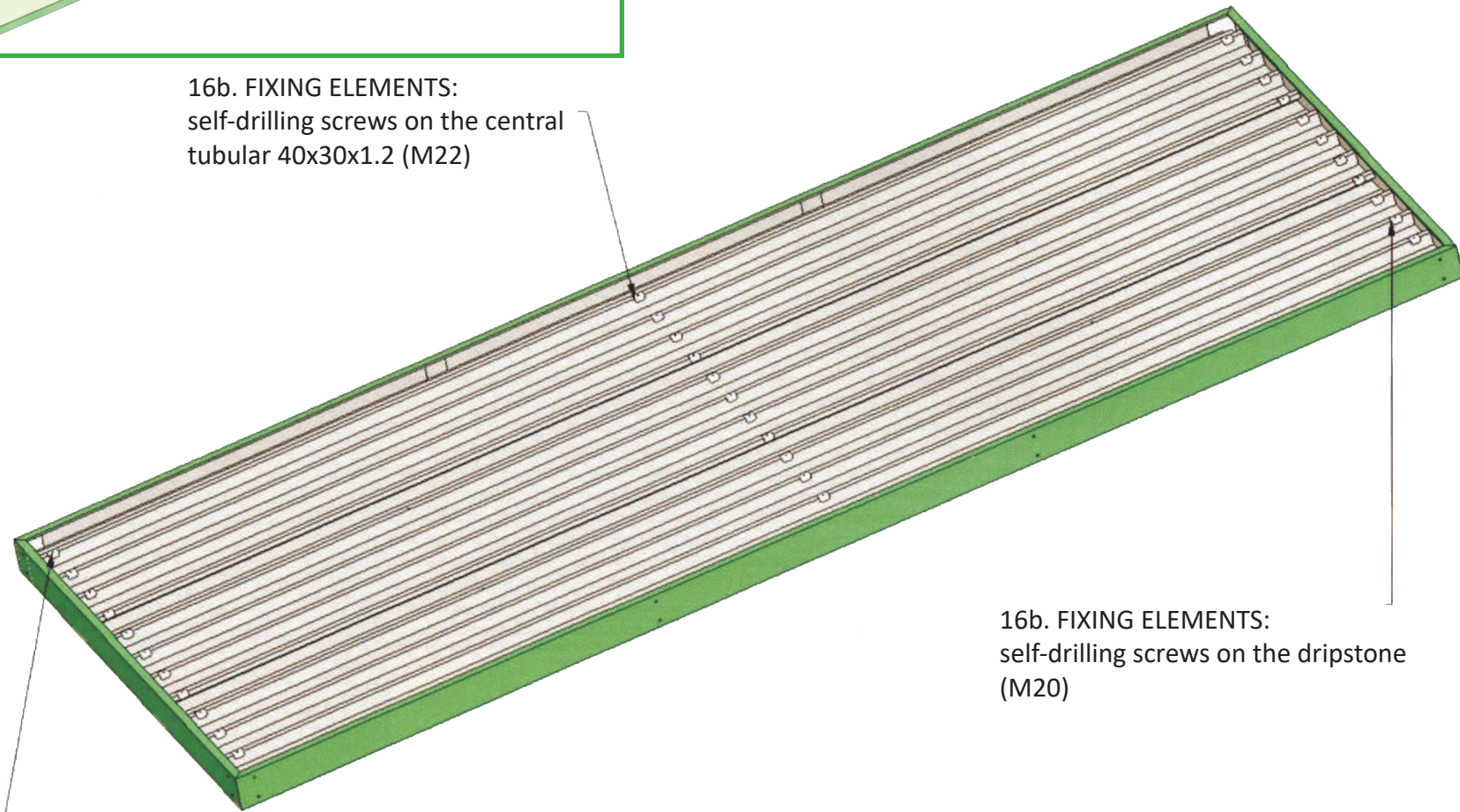

16b. FIXING ELEMENTS:
self-drilling screws on the dripstone (M20)

16b. FIXING ELEMENTS:
self-drilling screws on the dripstone (M20)



Note: Frame Colour is RAL 9002 Grey/White

| ROOF (20' OR LONGER) | | |
|----------------------|----------|------------------------|
| ELEMENT REF. | QUANTITY | DESCRIPTION |
| M24 | - | GALVANISED STEEL SHEET |



INSERT PANELS, DOORS AND WINDOWS, FINISHING

Sandwich panels to be fixed with rivets or self drilling screw to Inside Profile (Panels Holder M12) with one or more rivets and to the top roof frame with one or more rivets or self drilling screws.

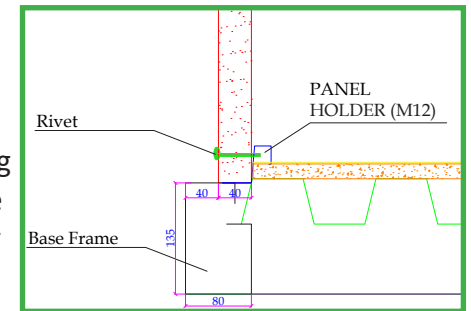

| FINISHING | | |
|--------------|----------|-------------------------|
| ELEMENT REF. | QUANTITY | DESCRIPTION |
| M14IN | 4 | COLUMN INSIDE FINISHING |